



# CELTIC

MINI SCONCES WALL

location:  
**DAMP**

## SPECIFICATIONS:

### DESCRIPTION

Wall-mounted sconce featuring handcrafted glass.

### LAMPING

**Standard:** 60W A19 120V incandescent, suitable for dimming, lamp not included. *(Incandescent dimmer is suitable for dimming, not included)*

**LED:** 9W Replaceable source, 120V, dimmable, 90+ CRI, 3000°K CCT, 800 lumens, 30,000 hours, lamp included. (For Opal/Clear only).

**LED Edison:** 8W Replaceable A19 LED Filament lamp, 120V, dimmable, 90+ CRI, 3000°K CCT, 800 lumens, 30,000 hours, lamp included (For Bubble only).

### DIFFUSER

Shade shall be handcrafted glass of various decors.

6" L x 4.75" D x 7.65" H

### CONSTRUCTION

Fixture utilizes die-cast arm assembly and stamped steel canopy (4.75" H), with plated metal finish.

### METAL FINISH

Fixture shall be finished in Bronze, Chrome or Satin Nickel.

### MOUNTING

Installs directly to a 4" octagonal outlet box. Orient upward or downward, wall-mount only.

### LABELS

UL or ETL Listed. Suitable for Damp Locations (interior use only).



CELTIC SHOWN IN OPAL GLOSSY/CLEAR (CELTICCL) IN CHROME FINISH

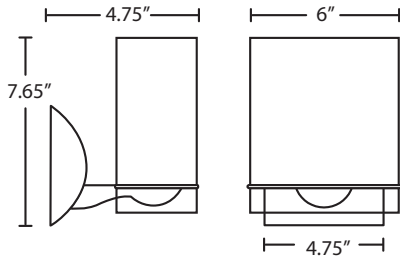

CELTICBB  
BUBBLE



## ORDERING:

FIXTURE	GLASS OPTIONS	LAMPING OPTIONS	METAL FINISH
1WZ Sconce	CELTICBB Bubble CELTICCL Opal/Clear	(blank) 60W A19 Incan LED 9W LED (For Opal/Clear) EDIL 8W LED Filament (For Bubble)	BR Bronze CR Chrome SN Satin Nickel

**Ex. 1WZ-CELTICCL-SN**  
Celtic Mini Sconce w/ Clear Glass,  
Satin Nickel Finish

### Project Information:

All dimensions provided are nominal.  
Allowance must be made for dimensional tolerance in handcrafted glasses.

REV 12/18