

# GLASS SHADE INSTALLATION GUIDE

Model B Series -03 (E12 Base Pendant Set 120V)

Q Series -03 (G9 Base Pendant Set 120V)

BKIT.03, Rev.5 12-11



BESALIGHTING

6695 Taylor Rd. Blacklick, OH 43004  
www.besalighting.com

**IMPORTANT:** For installation of pendants and wiring, please refer to the **Fixture Installation Guide** included with fixture canopy

## Use With these Models:

- Tutu (4121xx)
- Pera 6 (1713xx)
- Copa (4930xx)

1. Secure Glass Shade per the diagram above, then install bulb per label on luminaire.

**IMPORTANT:** For glass with a closed bottom, the lamp must be installed prior to installation of the glass.

2. Restore power.

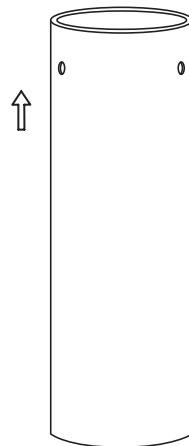
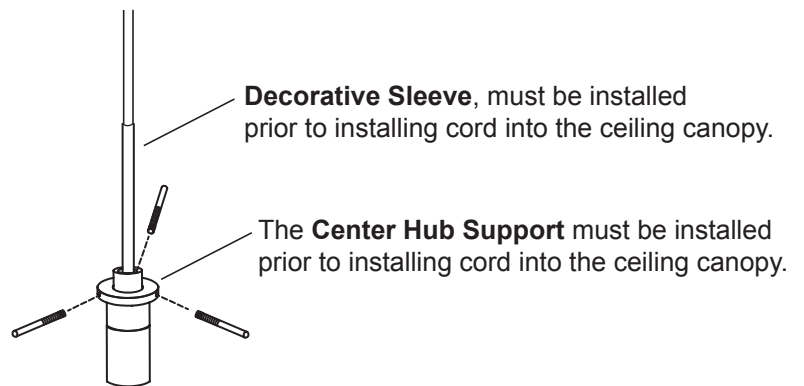

Note: Glass Shade is for instructional purposes. Actual Glass Shade may vary in size and shape.

Install the glass shade by positioning over the lampholder and then threading the Decorative Posts into the Center Hub Support.

All electrical connections and the installation of this fixture must be in agreement with local codes, ordinances or the NEC (National Electric Code) or CEC (Canadian Electrical Code). Do not connect this fixture to an electrical system that does not provide a means for equipment grounding.

### Replacement parts for this 120V Voltage Pendant Set are as follows:

#TB310C50-SN.03 - 50W 10' clear cordset with Nickel Hardware

#TQ310C40-SN.03 (lamp included) - 40W 10' clear cordset with Nickel Hardware

For Bronze cordset, use "Z" in place of "C" and "BR" in place of "SN". For 15' cordset, use "315" in place of "310"

### Lamps Only

#B5513 - 40W G9 Halogen, 120V