

# QUICK CONNECT INSTALLATION GUIDE

Model XP Willow LED Series (Low Voltage LED Pendant Set 12V)



BESA LIGHTING

6695 Taylor Rd. Blacklick, OH 43004  
www.besalighting.com

XP\_Willow\_LED, Rev.1 5-13

This low voltage Pendant Cord Assembly has been designed to be used with Besa Low Voltage Quick Connect Adapters. Operate with a low voltage transformer (12V) and never wire directly to 120 volts.

1. Making a clean cut, shorten the cord to the desired length.

2. Carefully strip off 1-3/4" of the outer jacket using the Stripping Tool provided.

**It is important not to damage the inner silver braiding. Practice this step on a scrap section of cord first.**

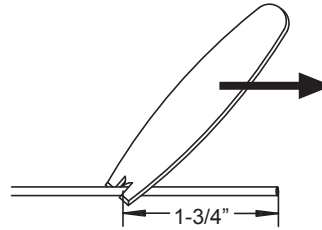

3. Slide the Brass Collar over the braiding. Make sure the Brass Collar does not damage the braiding to ensure a good connection.

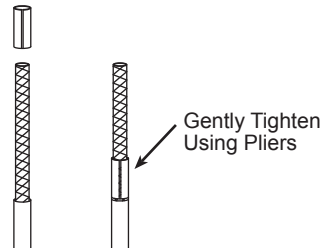

4. Remove the exposed braiding by pulling away from the center conductor, then cutting off excess. Leave 1/16" of braided material or less.

5. Strip off 1/8" of insulation from the Center Conductor. The exposed stranded wire of the Center Conductor must be tightly wound before proceeding.

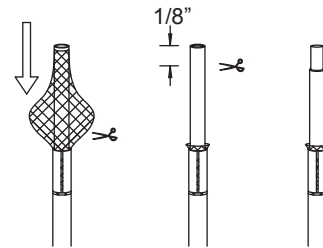

6. Feed the wire until it reaches the top set screw position. Confirm by viewing the Center Conductor through the Viewing Hole.

7. The Brass Collar should align with the bottom of the Quick Connect Jack, if not then trim the Center Conductor.

8. Tighten the top set screw first, then the lower. Do not overtighten the set screws and make sure the set screws avoid the seam in the Brass Collar. The pendant can now be installed onto Quick Connect Adapter.

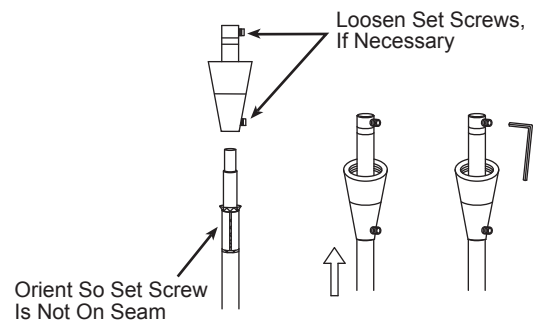

9. Insert the post of the Quick Connect Jack into the Quick Connect Adapter. Thread the top half of the conical section until it seats with the adapter.

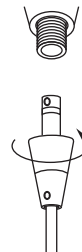

## IMPORTANT: KEEP THESE INSTRUCTIONS FOR YOUR RECORDS

All electrical connections and the installation of this fixture must be in agreement with local codes, ordinances or the NEC (National Electric Code) or CEC (Canadian Electrical Code).  
Do not connect this fixture to an electrical system that does not provide a means for equipment grounding.



## GLASS SHADE INSTALLATION GUIDE

### Use With these Models:

- Willow  
(1688WW)

1. Install Glass by sliding the Glass over the Lightsource and aligning the holes of the Glass to the holes of the Lightsource.
2. Install Posts through the holes in the Glass and thread into the Lightsource to secure the Glass.
3. With provided Crystal-rods, install each by sliding one by one into the bottom opening of the Glass. Adjust each Crystal-rod accordingly to meet desired look.

**NOTE:** Crystal-rods are accents included with the fixture, but customizable accents are optional.

4. Restore power.

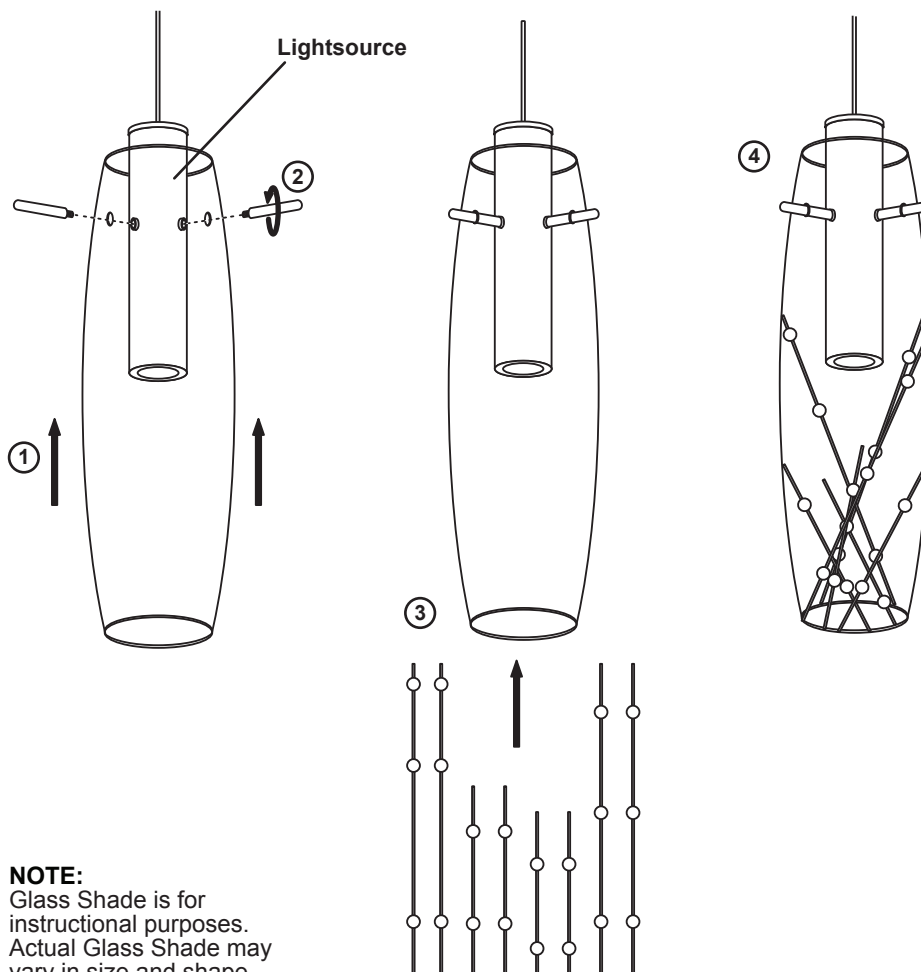

**NOTE:**  
Glass Shade is for  
instructional purposes.  
Actual Glass Shade may  
vary in size and shape.

All electrical connections and the installation of this fixture must be in agreement with local codes, ordinances or the NEC (National Electric Code) or CEC (Canadian Electrical Code).  
Do not connect this fixture to an electrical system that does not provide a means for equipment grounding.

# FIXTURE INSTALLATION GUIDE

Model Willow LED (1 Light Low Voltage LED Dome Canopy)



BESA LIGHTING

6695 Taylor Rd. Blacklick, OH 43004  
www.besalighting.com

1XT-1XC\_Willow\_LED, Rev.1 5-13

**IMPORTANT:** This 3W LED Pendant requires a constant current driver for proper operation. Incorrect polarity from the driver will result in the LEDs not illuminating.

**CAUTION:** Turn off power to electrical box before installing

1. Carefully unpack parts. Secure Mounting Plate (A) to the Outlet Box with Mounting Screws (B). Pull House Supply wires and House Ground through Mounting Plate Hole.

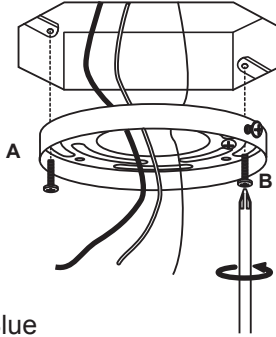

2. Connect the LED Driver Leads to the House Supply Wires with Wire Nut Connectors (C) as shown: Brown Driver Lead to Black House Supply Wire and Blue Driver Lead to White House Supply Wire. Then connect the LED Driver Leads to the Pendant Cord Leads with Wire Nut Connectors (D) as shown: Red Driver Lead to Clear Inner Lead and Black Driver Lead to Braided Outer Lead. Connect the House Ground Wire to the Canopy Ground Wire with Wire Nut Connector (E). Carefully push the wires and wire nuts back into the Outlet Box.

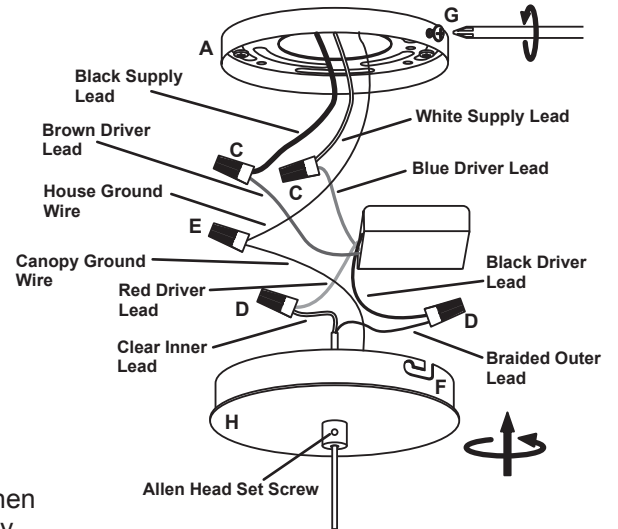

3. Align Canopy Slot Opening (F) with Mounting Plate Screw (G), then install Canopy (H) onto Mounting Plate (A) by rotating the Canopy Clock-wise. Then tighten the Mounting Plate Screws (G) to secure Canopy in place.
4. Adjust the height of pendant by loosening Set Screw, using the provided Allen Wrench, and lowering or raising the pendant to desired height. Once length of pendant at desired height, tighten Set Screw using the provided Allen Wrench to secure pendant in place.

## GLASS INSTALLATION:

5. Install Glass by sliding the Glass over the Lightsource and aligning the holes of the Glass to the holes of the Lightsource.
6. Install Posts through the holes in the Glass and thread into the Lightsource to secure the Glass.
7. With provided Crystal-rods, install each by sliding one by one into the bottom opening of the Glass. Adjust each Crystal-rod accordingly to meet desired look.

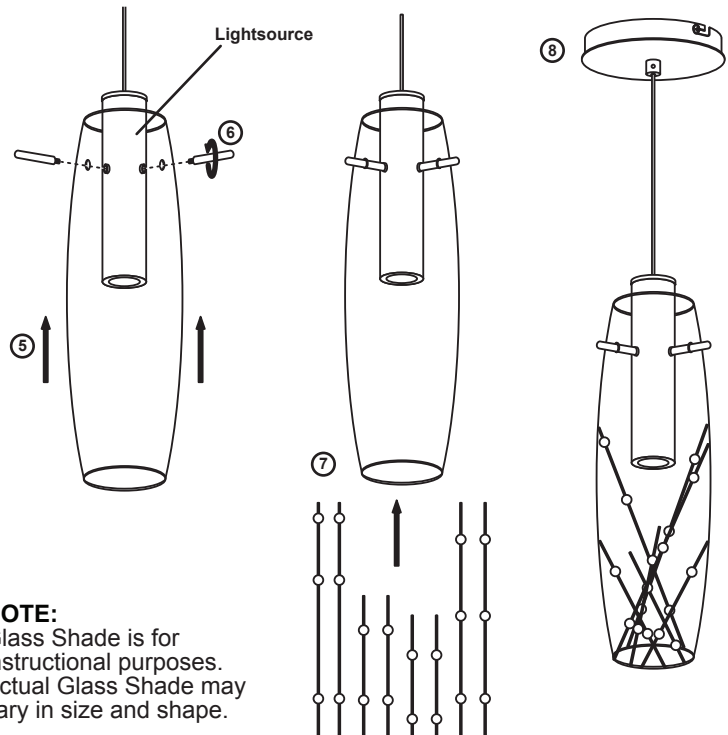

8. Restore power.

All electrical connections and the installation of this fixture must be in agreement with local codes, ordinances or the NEC (National Electric Code) or CEC (Canadian Electrical Code). Do not connect this fixture to an electrical system that does not provide a means for equipment grounding.